

VIEW 4 (1:500)

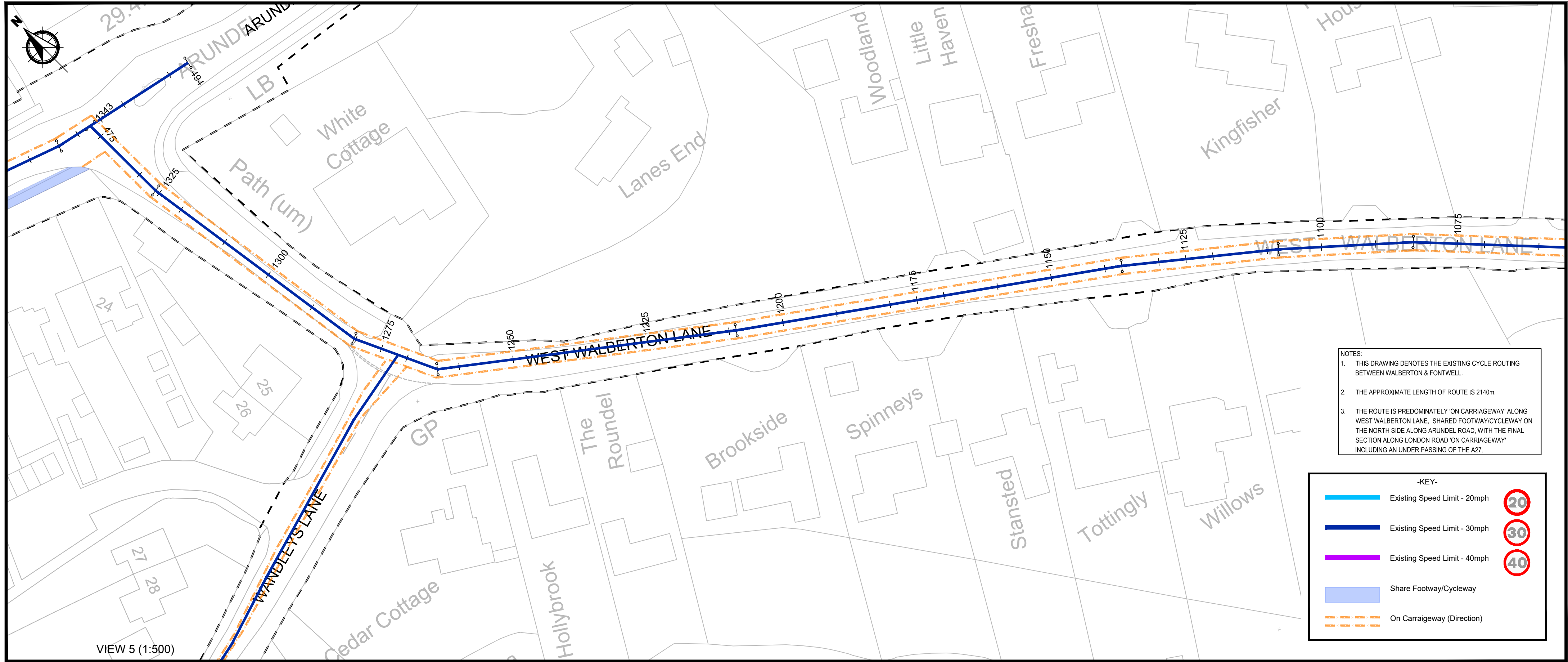

VIEW 5 (1:500)

- NOTES:
1. THIS DRAWING DENOTES THE EXISTING CYCLE ROUTING BETWEEN WALBERTON & FONTWELL.
 2. THE APPROXIMATE LENGTH OF ROUTE IS 2140m.
 3. THE ROUTE IS PREDOMINATELY 'ON CARRIAGEWAY' ALONG WEST WALBERTON LANE. SHARED FOOTWAY/CYCLEWAY ON THE NORTH SIDE ALONG ARUNDEL ROAD, WITH THE FINAL SECTION ALONG LONDON ROAD 'ON CARRIAGEWAY' INCLUDING AN UNDER PASSING OF THE A27.

-KEY-

- Existing Speed Limit - 20mph
- Existing Speed Limit - 30mph
- Existing Speed Limit - 40mph
- Share Footway/Cycleway
- On Carraighway (Direction)

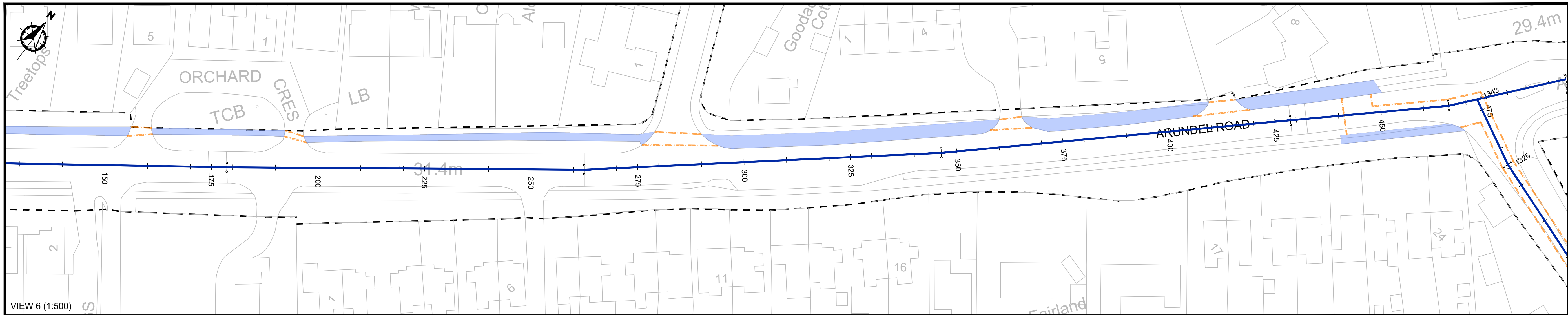

VIEW 6 (1:500)

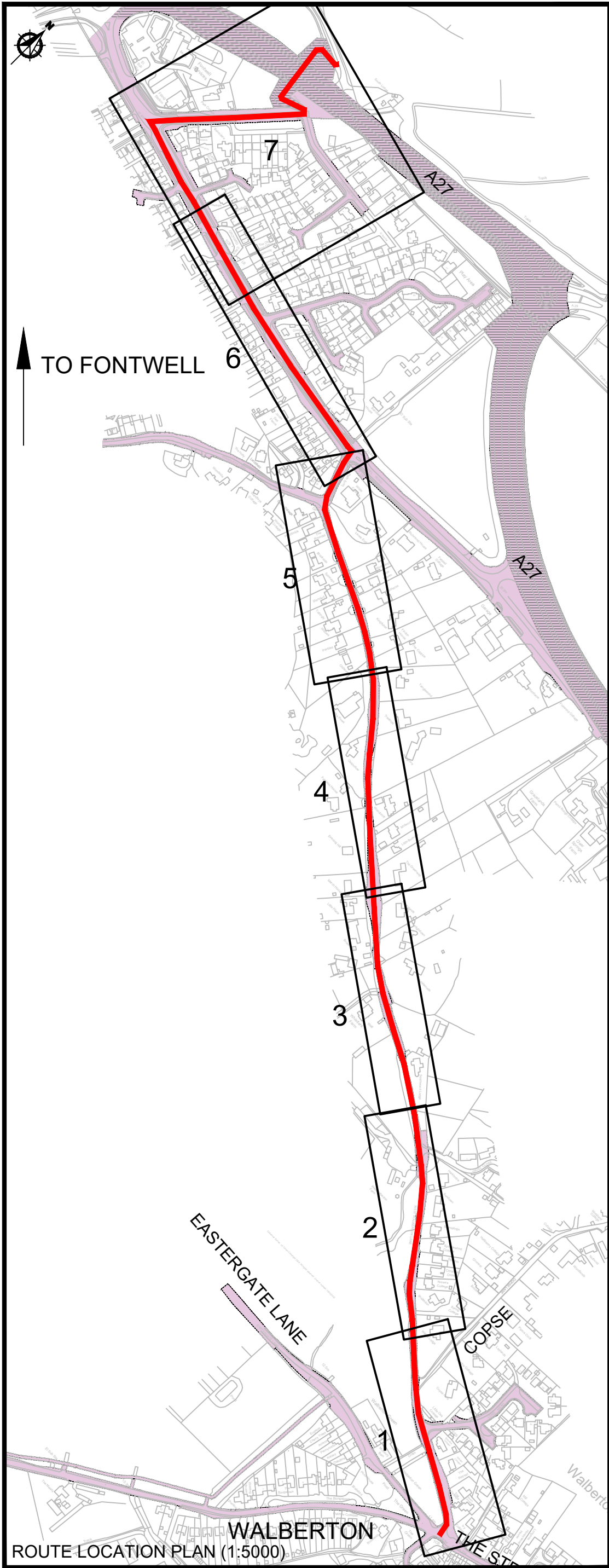
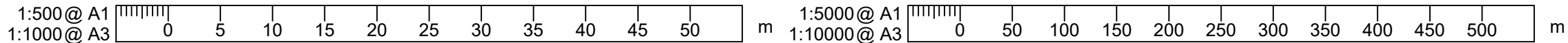

ROUTE LOCATION PLAN (1:5000)

NOTES

1. This drawing is to be read in conjunction with all other BP Civils drawings, and with all relevant Architect's and Engineer's drawings and specification. Any discrepancies found are to be reported immediately to the Engineer.
2. BP Civils accepts no responsibility for inaccuracies in data provided by third parties such as topographic surveys or Ordnance Survey mapping.
3. Do not scale. Work to figured dimensions only. All dimensions are in millimeters unless noted otherwise and all levels are in metres from the topographic survey datum.
4. Any information given regarding existing underground services is given in good faith after consultation with the relevant authority, however accuracy is not certain. The main contractor is responsible for checking all information on site prior to work commencing and taking due care whilst undertaking the works.
5. All dimensions to be checked on site. All details and dimensions relating to sub-contractors work must be checked and agreed between the sub-contractor or supplier and the general contractor.
6. The electronic information from this drawing can not be guaranteed as dimensionally drawn exact. Figured dimensions must be used for setting out and detailing. BP Civils logos and company information must be removed from copies if information is re-used.
7. Where used, this map is based on or reproduced from Ordnance Survey material with the permission of Ordnance Survey on behalf of the controller of His Majesty's Stationary Office (© Crown Copyright). Licence number: 100022432. BP Civils accept no liability for any inaccuracies with the data.

A	25.11.24	General update
-	19.06.24	Original Issue
Rev.	Date	Amendments



BP CIVILS
Infrastructure Design and Transport Planning Consultants
2 West Barn, Norton Lane, Chichester, West Sussex PO20 3AF
Tel: 0333 358 3260
www.bpcivils.co.uk enquiries@bpcivils.co.uk

Drawing Status
FOR INFORMATION
NOT FOR CONSTRUCTION

Client
Walberton Parish Council

Project
Walberton Parish Cycle
Strategy Scheme

Drawing Title
Route 2 - Walberton - Fontwell
Sheet 2 of 3

Scale at A1 Date Drawn By Checked By Project No.
AS SHOWN June 24 JHL MJA D2265

Drawing No.
000-BPC-WD-ZZ-D-C-SK13

Rev.
A